

Top of the line grease gun for heavy industrial applications

- Built Tough**
- Barrel with 0.049" (1.2 mm) wall thickness
 - Heavy duty follower spring
 - High tolerance CNC machined, aluminium die cast head
 - Rolled threads for quick & easy re-loading

Variable Stroke
Convenient greasing even in tight spaces with limited movement of handle

- Available in 2 choices**
- 6" (150 mm) steel extension & coupler
 - 12" (300 mm) x 0.33" (8.5 mm) flexible hose & coupler

SPECIFICATIONS

DEVELOPS	UPTO 10,000 PSI	UPTO 690 BAR
DELIVERS	UPTO 1 OZ. / 28 STROKES	UPTO 1 GM / STROKE



Aluminium die cast head with bulk loader and air bleeder valve

FILLING OPTIONS

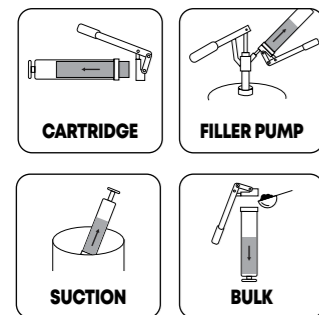

VARIANTS

G1-HD		2-1/4" (57.15 mm)	Use with 14 oz. (400 gms) grease cartridge/500cc bulk grease
G4-HD		63.5 mm	Use with 450gms grease cartridge popular in Australia & New Zealand
G10-HD		2-1/4" (57.15 mm)	High capacity gun Use with 14 oz. (400 gm) grease cartridge/ 24 oz. (750cc) bulk grease
NEW!		2-11/32" (59.7 MM)	Extra large grease gun Use with 600 gms grease cartridge popular in Italy

ORDERING INFORMATION

CAT NR.	ORD NR.	CAT NR.	ORD NR.	CARTRIDGE CAPACITY		BULK CAPACITY (CM ³)	THREADS	BOX QTY.
				(OZ.)	(GMS)			
6" (150 MM) STEEL EXTENSION & COUPLER				12" (300 MM) FLEXIBLE HOSE & COUPLER				
* G1R/HD/B	42700	G1F/HD/B	42720	14	400	500	1/8" BSPT	16
* G1R/HD/M	42701	G1F/HD/M	42721	14	400	500	M10 x 1	16
* G1R/HD/N	42702	G1F/HD/N	42722	14	400	500	1/8" NPT	16
* G4R/HD/B	42780	G4F/HD/B	42785	-	450	650	1/8" BSPT	16
G10R/HD/B	42750	G10F/HD/B	42760	14	400	750	1/8" BSPT	10
G10R/HD/M	42751	G10F/HD/M	42761	14	400	750	M10 x 1	10
G10R/HD/N	42752	G10F/HD/N	42762	14	400	750	1/8" NPT	10
◆ G18R/HD/M	42753	◆ G18F/HD/M	42763	-	600	700	M10 x 1	10

* Best Seller ◆ New